

# gathering



RIGHT SIDE  
OF FABRIC



BACK SIDE  
OF FABRIC

## SEWING TWO ROW GATHERS

**1.** The most common way to create gathers is to use a long, straight machine stitch.

Loosen the needle thread tension slightly. This will make it easier to pull up the bobbin thread later.

Set the stitch length for a long stitch; the heavier the fabric, the longer the stitch.

Working on the right side of the fabric, stitch along seamline or slightly inside the seamline of the area to be gathered. Stitch again  $\frac{1}{4}$ " (6mm) away, within seam allowance. Be sure to leave long thread tails and do not back stitch.

**2.** To pull up the gathers, draw the long thread ends to the back side of the gathers section, then with right sides together, pin the gathers and flat section together.

Anchor the thread ends on one end of the gathered section around a pin in a figure 8. At the other end, pull up the bobbin threads until the gathers fit. Distribute the fullness evenly. Anchor threads around a pin.

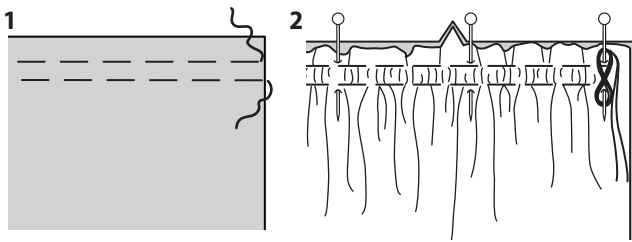

## GATHERING WITH YARN

**1.** This fast method for gathering a long section eliminates any worries about threads breaking.

Cut a piece of strong thin yarn or cord that is slightly longer than the edge to be gathered. Set your machine for a zigzag stitch wide enough to stitch over the yarn without catching. Position yarn within the seam allowance so that the left swing of the needle falls just short of the seamline and stitch.

**2.** Wrap one end of the yarn around the pin in figure eight to secure it. Hold the yarn taut then slide the fabric along the yarn. Even out the gathers.

Pin the gathered and flat sections together, matching notches, seamlines and markings.

Set the machine stitch back to normal. Working with the gathered side up, stitch along the seamline, being careful not to catch the yarn.

When the seam is completely stitched, gently pull out the yarn.

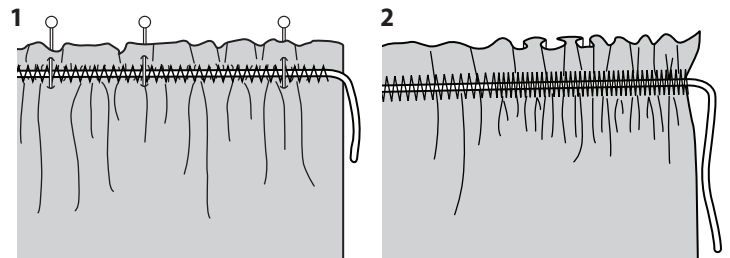

## GATHERS INTERSECTING A SEAM

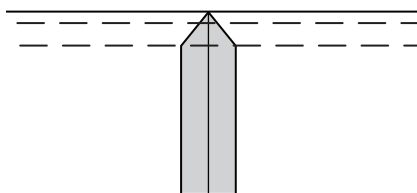

**ON LIGHT AND MEDIUM WEIGHT FABRICS**

Trim the ends of the allowances diagonally before stitching gathers.

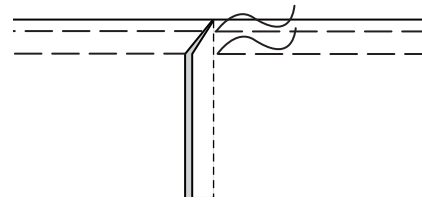

**ON BULKY FABRICS**

Trim seam ends; keeping the seam allowance free.